

NMRV

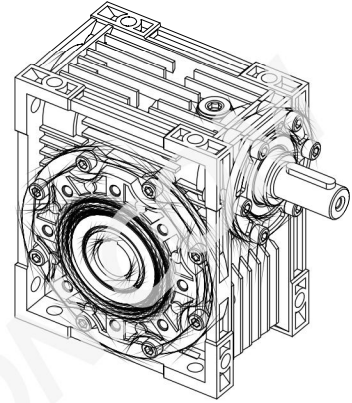

NRV

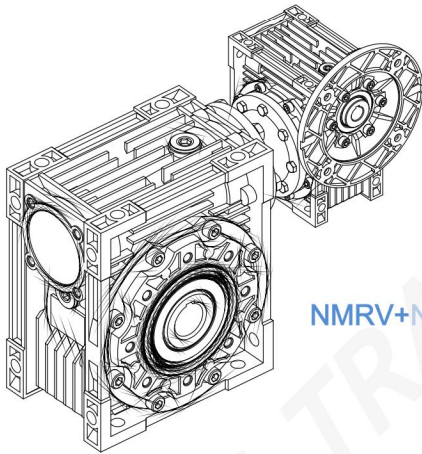

NMRV+NMRV

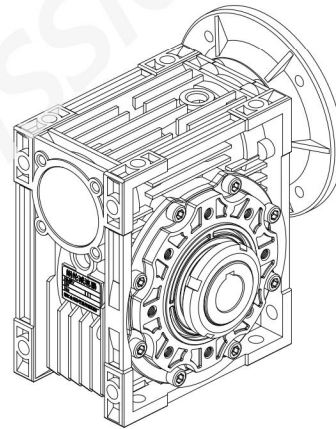

NMRL

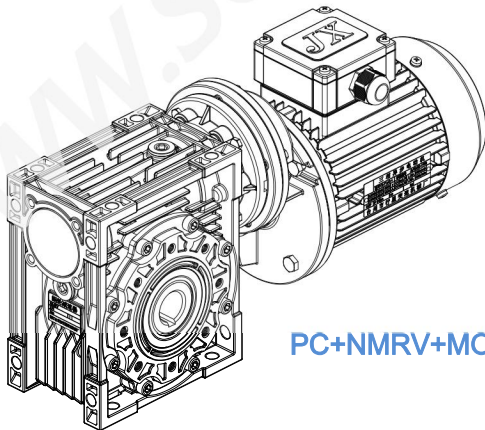

PC+NMRV+MOTOR

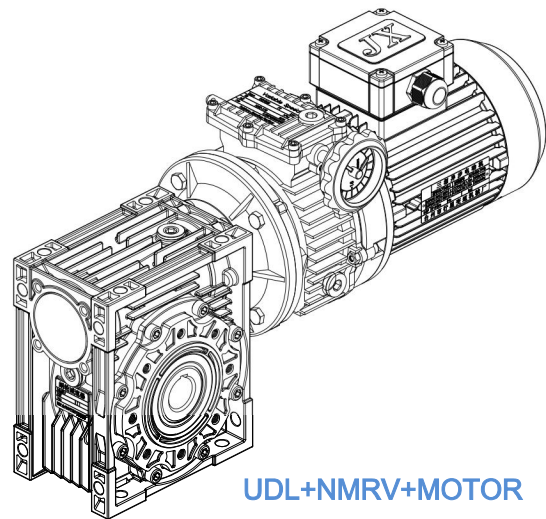

UDL+NMRV+MOTOR

1.0 结构分解图和机型版本

1.0 EXPLODED VIEW AND VERSIONS

1.1 NMRV 构分解图

1.1 NMRV Exploded view

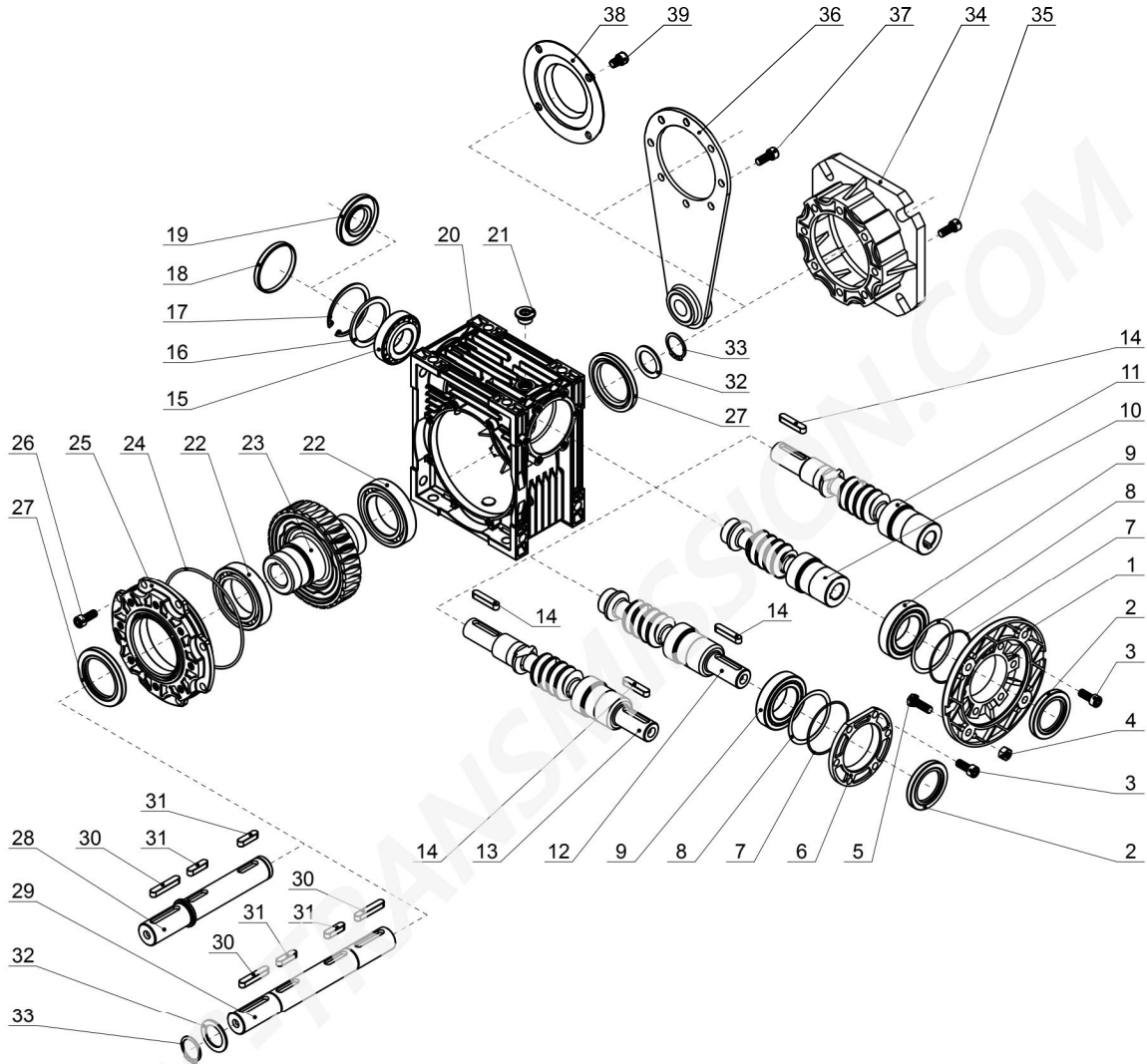

1	电机法兰 Flange PAM	11	孔输入轴输入蜗杆 Double ext. PAM worm	21	油塞 Oli plug	31	平键 Parallel key
2	油封 Oli seal	12	轴输入蜗杆 RV worm	22	轴承 Bearing	32	垫圈 Washer
3	内六角圆柱头螺钉 Hexagon socket head cap screw	13	双轴输入蜗杆 Double ext. RV worm	23	蜗轮 Worm wheel	33	轴用弹性挡圈 Circlip for shaft
4	六角螺母 Hexagon nuts	14	平键 Parallel key	24	O形橡胶密封圈 O-ring	34	输出法兰 Output flange
5	六角头螺栓 Hexagon bolt	15	轴承 Bearing	25	侧盖 Bearing support cover	35	内六角圆柱头螺钉 Hexagon socket head cap screw
6	输入端盖 Gear unit cover	16	垫圈 Washer	26	内六角圆柱头螺钉 Hexagon socket head cap screw	36	扭力臂 Torque arm
7	O形橡胶密封圈 O-ring	17	孔用弹性挡圈 Circlip for hole	27	油封 Oli seal	37	内六角圆柱头螺钉 Hexagon socket head cap screw
8	调整垫片 Spacer shim	18	盖子 Cap	28	单向输出轴 Single output Shaft	38	保护盖 Protection cap
9	轴承 Bearing	19	油封 Oli seal	29	双向输出轴 Double output Shaft	39	内六角圆柱头螺钉 Hexagon socket head cap screw
10	孔输入蜗杆 PAM worm	20	箱体 Case	30	平键 Parallel key		

1.2 PC 结构分解图

1.2 PC Exploded view

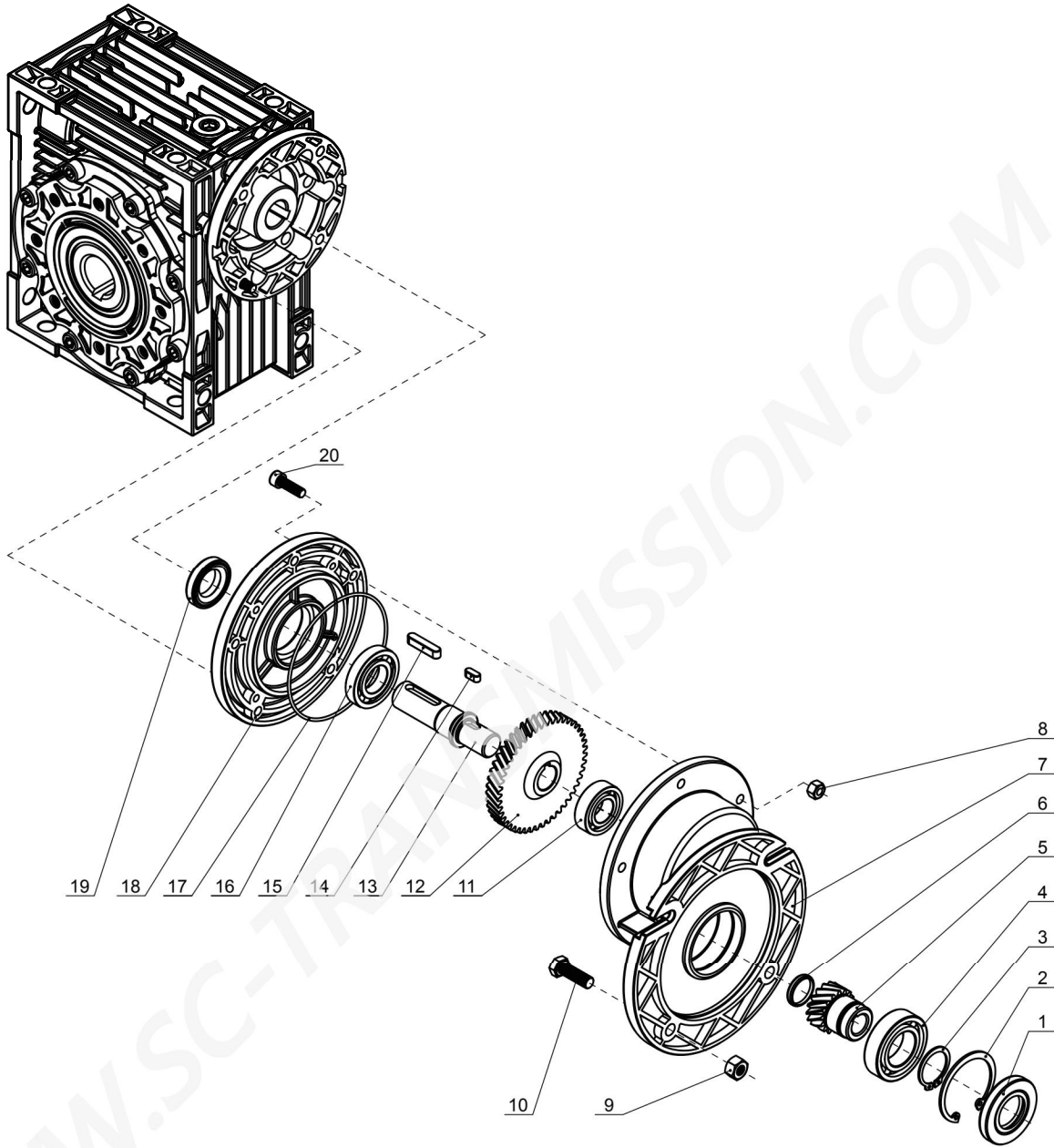

1	油封 Oli seal	6	盖子 Cap	11	轴承 Bearing	16	轴承 Bearing
2	孔用弹性挡圈 Circlip for hole	7	前置齿轮箱体 Pre-stage unit case	12	大齿轮 Gear	17	O形橡胶密封圈 O-ring
3	轴用弹性挡圈 Circlip for shaft	8	六角螺母 Hexagon nuts	13	输出轴 Low speed shaft	18	输出端盖 Output cover
4	轴承 Bearing	9	六角螺母 Hexagon nuts	14	平键 Parallel key	19	油封 Oli seal
5	孔输入小齿轮 Hollow pinion	10	六角头螺栓 Hexagon bolt	15	平键 Parallel key	20	内六角圆柱头螺钉 Hexagon socket head cap screw

1.3 蜗杆减速器机型版本

1.3 Versions

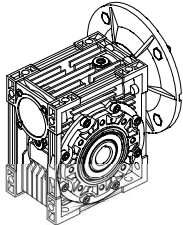
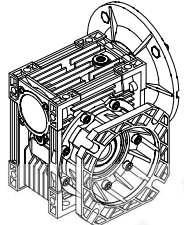
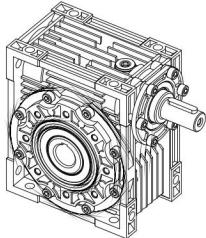
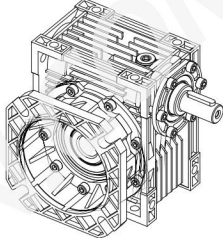
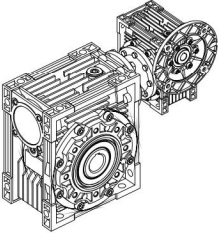
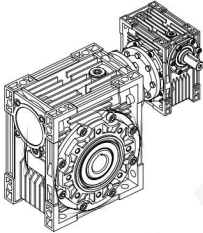
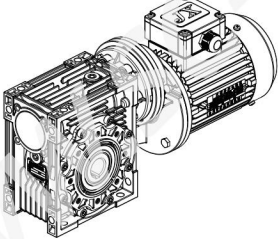
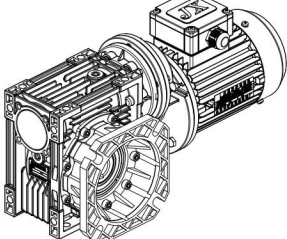
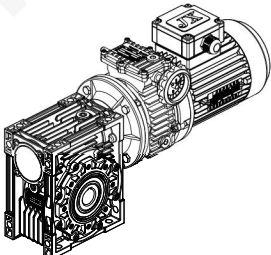
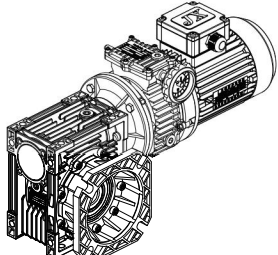
	NMRV 025 - 150	NMRV 025 - 150 F	
	025 - 150 NRV	025 - 150 F NRV	
	NMRV+NMRV 025/030 - 063/150	NMR+NMRV 025/030 - 063/150 F	
	NRV+NRV 025/030 - 063/150	NRV+NRV 025/030 - 063/150 F	
	PC+NMRV +MOTOR 063/040 - 090/130	PC+NMRV +MOTOR 063/040 - 090/130 F	
	UDL+NMRV 002/040 - 050/130	UDL+NMRV 002/040 - 050/130 F	

2.0 产品名称

NMRV

2.1 蜗杆减速器

2.0 DESIGNATION

NMRV

2.1 Worm speed reduction unit

类型 Type	减速比 Ratio	双向输入轴 Double input shaft	输出 Output	输入法兰 Input flange	安装方位 Mounting position	颜色 Color	电机 Electric motor
------------	--------------	-----------------------------	--------------	----------------------	---------------------------	-------------	----------------------

NMRV75 - 30 - VS - FA1-ASR-A1 - 80B5 - B3 - B - Y₂0.75-4 / 1

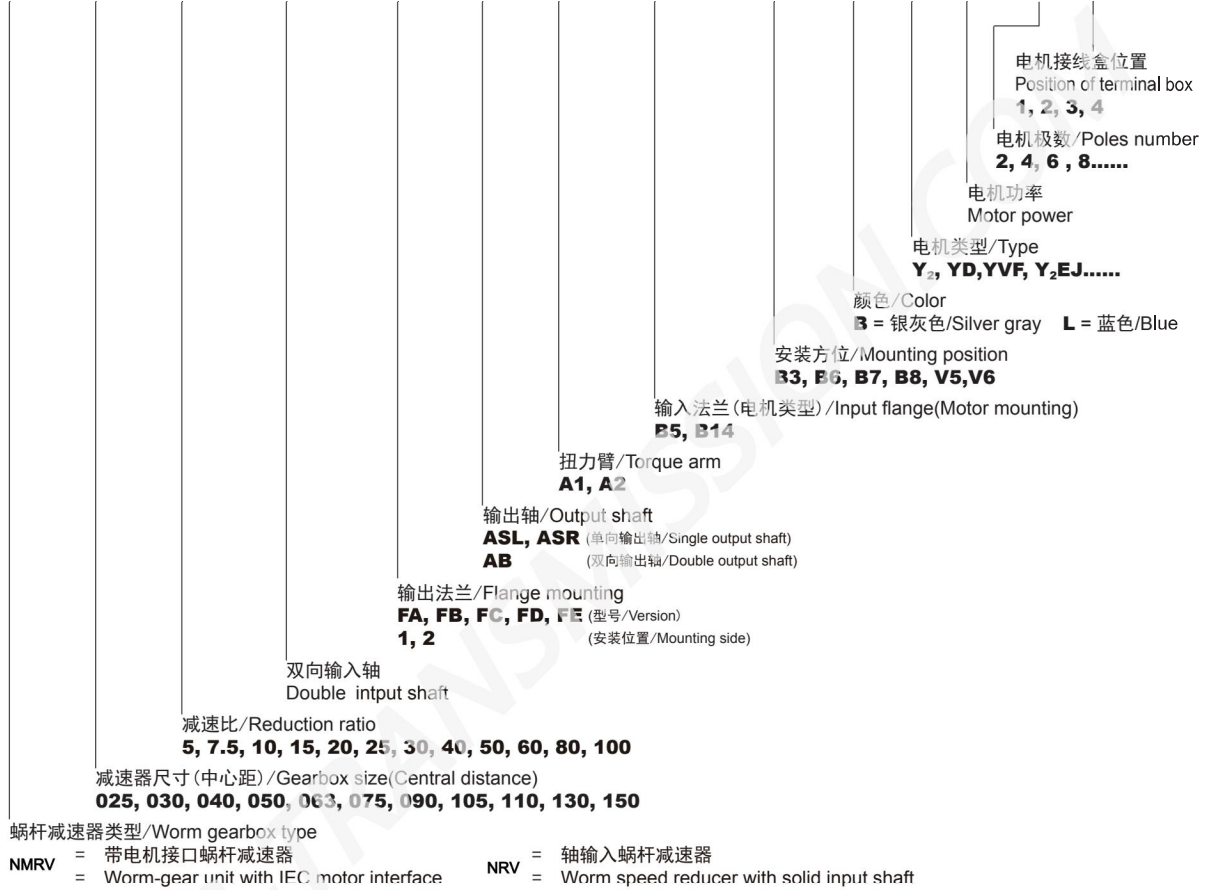

2.2 **PC+JMRV**
前置齿轮蜗杆减速器

2.2 **PC+JMRV**
Worm geared motors with Pre-stage helical unit

前置斜齿轮模块 Pre-stage helical unit	类型 Type	减速比 Ratio	双向输入轴 Double input shaft	输出法兰 Output flange	输出轴 Output shaft	安装方位 Mounting position	电机 Electric motor
-----------------------------------	------------	--------------	-----------------------------	-----------------------	---------------------	---------------------------	----------------------

PC 071 - NMRV75 - 30 - VS - FA1 - ASR - B3 - Y₂0.37-4 / 1

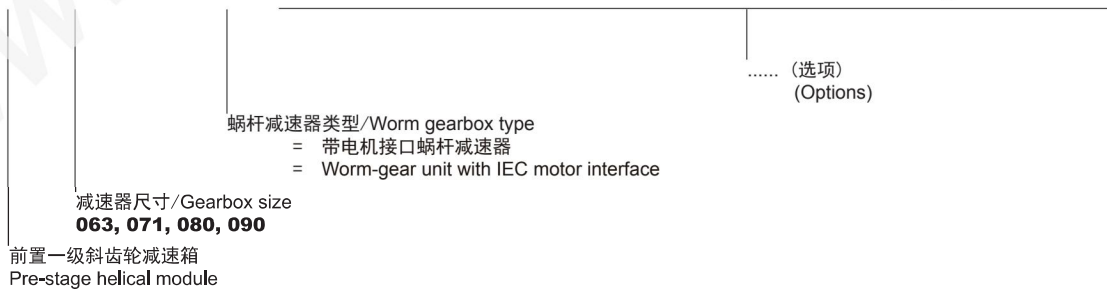

2.3 双蜗杆减速器

2.3 Combination worm-gear unit

类型 Type	减速比 Ratio	双向输入轴 Double input shaft	输出法兰 Output flange	输出轴 Output shaft	输入法兰 Input flange	安装方位 Mounting position	电机 Electric motor	
NMRV040/090 - 500 - VS - FA1 - ASR - 71B5 - AS1 - Y₂0.37-4 / 1								
	减速比/Reduction ratio 300, 400, 500, 600 (选项) (Options) 安装方位/Mounting position AS1, AS2, BS1, BS2, VS1, VS2, PS1, PS2		
减器尺寸(中心距)/Gearbox size(Central distance) 025/030 - 063/150			 (选项) (Options)				
Worm gearbox type 带电机接口蜗杆减速器 Worm-gear unit with IEC motor interface				轴输入蜗杆减速器 Worm speed reducer with solid input shaft				

2.4 UDL+JMRV
无级变速器和蜗杆减速器组合

2.4 UDL+JMRV
Combination of Stepless speed variator and Worm-gear unit

无级变速器 Stepless speed variator	类型 Type	减速比 Ratio	双向输入轴 Double input shaft	输出法兰 Output flange	输出轴 Output shaft	安装方位 Mounting position	电机 Electric motor
UDL 010 - NMRV75 - 30 - VS - FA1 - ASR - B3 - Y₂0.75-4 / 1							
	蜗杆减速器类型/Worm gearbox type NMRV = 带电机接口蜗杆减速器 = Worm-gear unit with IEC motor interface				 (选项) (Options)	
无级变速器尺寸/Stepless speed variator size 002, 005, 010, 020, 030, 050, 100							
无级变速器类型/Stepless speed variator type UDL, UD 系列 (UDL = 铝合金壳体, UD = 铸铁壳体) UDL, UD Series (UDL = Aluminium alloy housing, UD = Cast iron housing)				TXF 系列 TXF Series			

3.0 配置和组合

3.0 DISPOSITION AND COMBINATIONS

3.1 NMRV基本配置

3.1 NMRV Pre-disposition

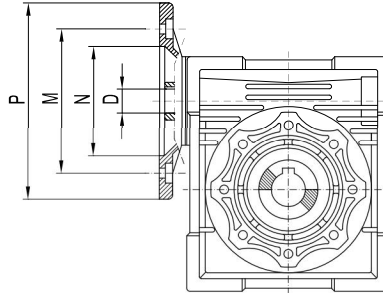

NMRV	PAM IEC	N	M	P	D											
					5	7.5	10	15	20	25	30	40	50	60	80	100
025	56B14	50	65	80	9	9	9	9	9	-	9	9	9	9	-	-
030	63B5	95	115	140	11	11	11	11	11	11	11	11	11	-	-	-
	63B14	60	75	90												
	56B5	80	100	120	9	9	9	9	9	9	9	9	9	9	9	-
	56B14	50	65	80												
040	71B5	110	130	160	14	14	14	14	14	14	14	14	-	-	-	-
	71B14	70	85	105												
	63B5	95	115	140	11	11	11	11	11	11	11	11	11	11	11	11
	63B14	60	75	90												
	56B5	80	100	120	-	-	-	-	-	-	-	-	9	9	9	9
050	80B5	130	165	200	19	19	19	19	19	19	19	-	-	-	-	-
	80B14	80	100	120												
	71B5	110	130	160	14	14	14	14	14	14	14	14	14	14	14	-
	71B14	70	85	105												
	63B5	95	115	140	-	-	-	-	-	-	-	11	11	11	11	11
063	90B5	130	165	200	-	24	24	24	24	24	24	-	-	-	-	-
	90B14	95	115	140												
	80B5	130	165	200	-	19	19	19	19	19	19	19	19	19	-	-
	80B14	80	100	120												
	71B5	110	130	160	-	-	-	-	-	-	-	14	14	14	14	14
	71B14	70	85	105												
075	100/112B5	180	215	250	-	28	28	28	-	-	-	-	-	-	-	-
	100/112B14	110	130	160												
	90B5	130	165	200	-	24	24	24	24	24	24	24	-	-	-	-
	90B14	95	115	140												
	80B5	130	165	200	-	-	-	-	19	19	19	19	19	19	19	19
	80B14	80	100	120												
	71B5	110	130	160	-	-	-	-	-	-	-	-	14	14	14	14
090	100/112B5	180	215	250	-	28	28	28	28	28	28	-	-	-	-	-
	100/112B14	110	130	160												
	90B5	130	165	200	-	24	24	24	24	24	24	24	24	24	-	-
	90B14	95	115	140												
	80B5	130	165	200	-	-	-	-	-	-	-	19	19	19	19	19
	80B14	80	100	120												
110	132B5	230	265	300	-	38	38	38	38	-	-	-	-	-	-	-
	100/112B5	180	215	250	-	28	28	28	28	28	28	28	28	28	-	-
	90B5	130	165	200	-	-	-	-	-	24	24	24	24	24	24	24
	80B5	130	165	200	-	-	-	-	-	-	-	-	-	-	19	19
130	132B5	230	265	300	-	38	38	38	38	38	38	38	38	-	-	-
	100/112B5	180	215	250	-	-	-	-	-	28	28	28	28	28	28	28
	90B5	130	165	200	-	-	-	-	-	-	-	-	-	-	24	24
150	160B5	250	300	350	-	42	42	42	42	42	-	-	-	-	-	-
	132B5	230	265	300	-	-	-	-	38	38	38	38	38	38	-	-
	100/112B5	180	215	250	-	-	-	-	-	-	-	-	28	28	28	28

3.2

组合方式

3.2

Possible combinations

NMRV	PC063		PC071		PC080			PC090			
	IEC	105/11	105/14	120/14	120/19	160/19	160/24	160/28	160/19	160/24	160/28
	i	i=2,93	i=2,93	i=2,94	i=2,94	i=3	i=3	i=3	i=2,45	i=2,45	i=2,45
040	25										
	30										
	40										
	50										
	60										
	100										
050	25										
	30										
	40										
	50										
	60										
	100										
063	25										
	30										
	40										
	50										
	60										
	100										
075	25										
	30										
	40										
	50										
	60										
	100										
090	25										
	30										
	40										
	50										
	60										
	100										
105 110	25										
	30										
	40										
	50										
	60										
	100										
130	25										
	30										
	40										
	50										
	60										
	100										

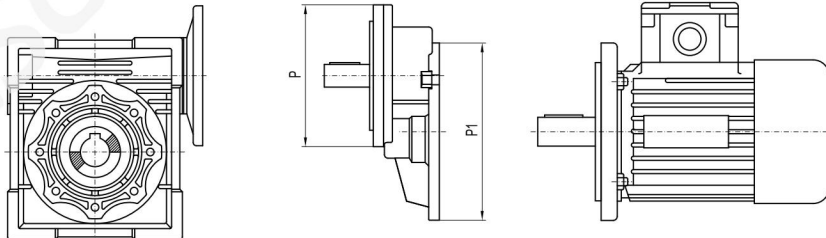

	P1	P	(P)
PC 063	63B5-140/11	105/11	(105/14)
PC 071	71B5-160/14	120/14	(120/19)
PC 080	80B5-200/19	160/19	(160/24) (160/28)
PC 090	90B5-200/24	160/24	(160/19) (160/28)

(..) 根据用户要求定制
(..) Only on request